

AEG 2013
Westin Seattle

September 10-13, 2013

JOB NO. 6978

A.E./SALES CS

- 40 - 8'x10' Booths
- 15 - Cocktails Rounds
- 10 - Poster Boards
- 2 - Registrations

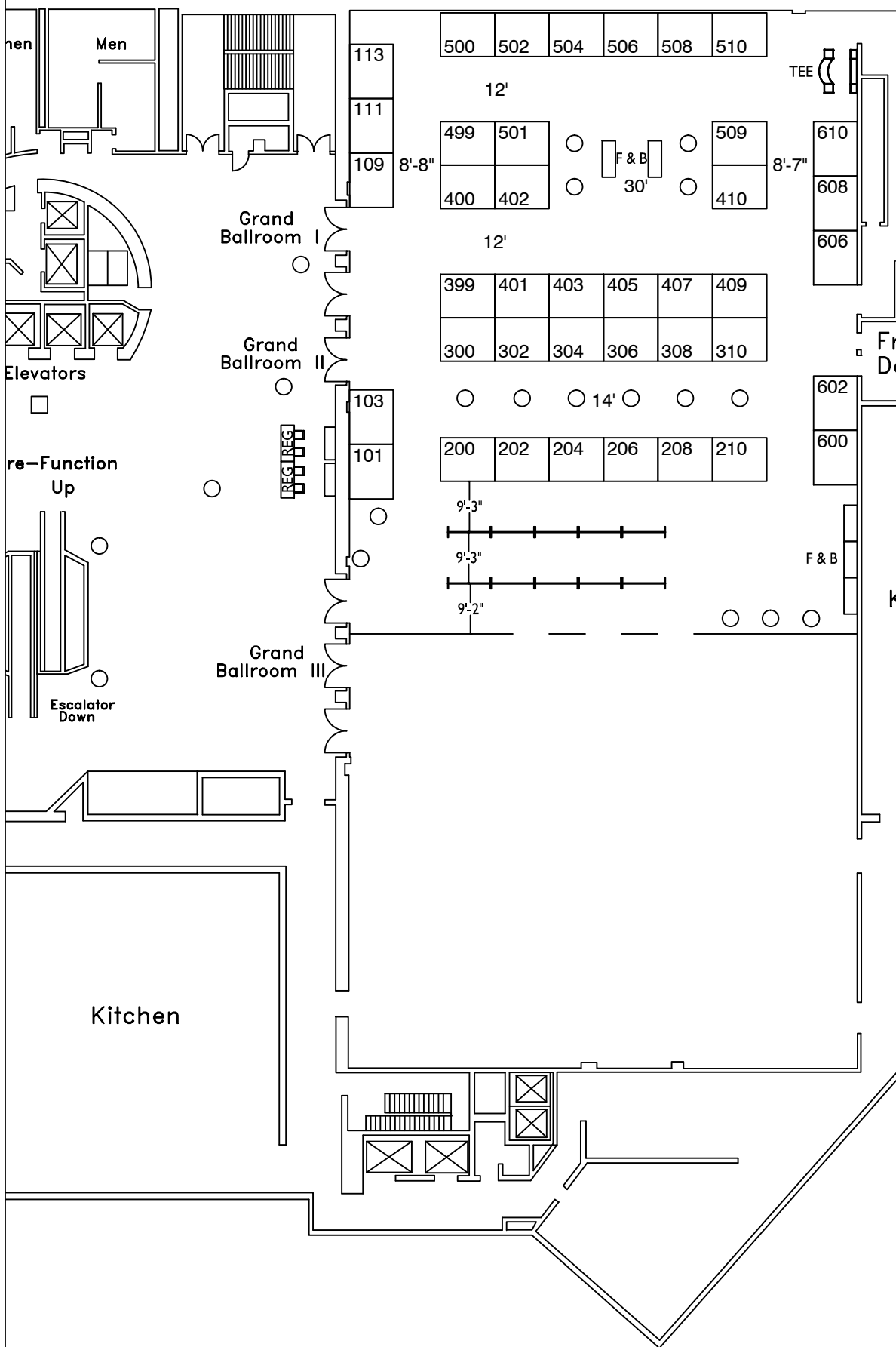
REVISION LOG

NO	DESCRIPTION
1	AEG v03.dwg
2	12/18/2012
3	John Wai TE&E

DISCLAIMER

EVERY EFFORT HAS BEEN MADE TO ENSURE THE ACCURACY OF ALL INFORMATION CONTAINED ON THIS FLOORPLAN. HOWEVER, NO WARRANTIES, EITHER EXPRESSED OR IMPLIED, ARE MADE WITH RESPECT TO THIS FLOORPLAN.

IF THE LOCATION OF BUILDING COLUMNS, UTILITIES, OR OTHER ARCHITECTURAL COMPONENTS OF THE FACILITY IS A CONSIDERATION IN THE CONSTRUCTION OR USAGE OF AN EXHIBIT, IT IS THE SOLE RESPONSIBILITY OF THE EXHIBITOR TO PHYSICALLY INSPECT THE FACILITY TO VERIFY ALL DIMENSIONS AND LOCATIONS.

(C) COPYRIGHT 2004, TRIUMPH EXPO & EVENTS, INC. ALL RIGHTS RESERVED.